







LEGENDE NUTSVOORZIENINGEN

-  aftappunt hemelwater - RW pomp
-  stadswater
-  wachtbuizen
-  hemelwater
-  fecaliën
-  huishoudelijk

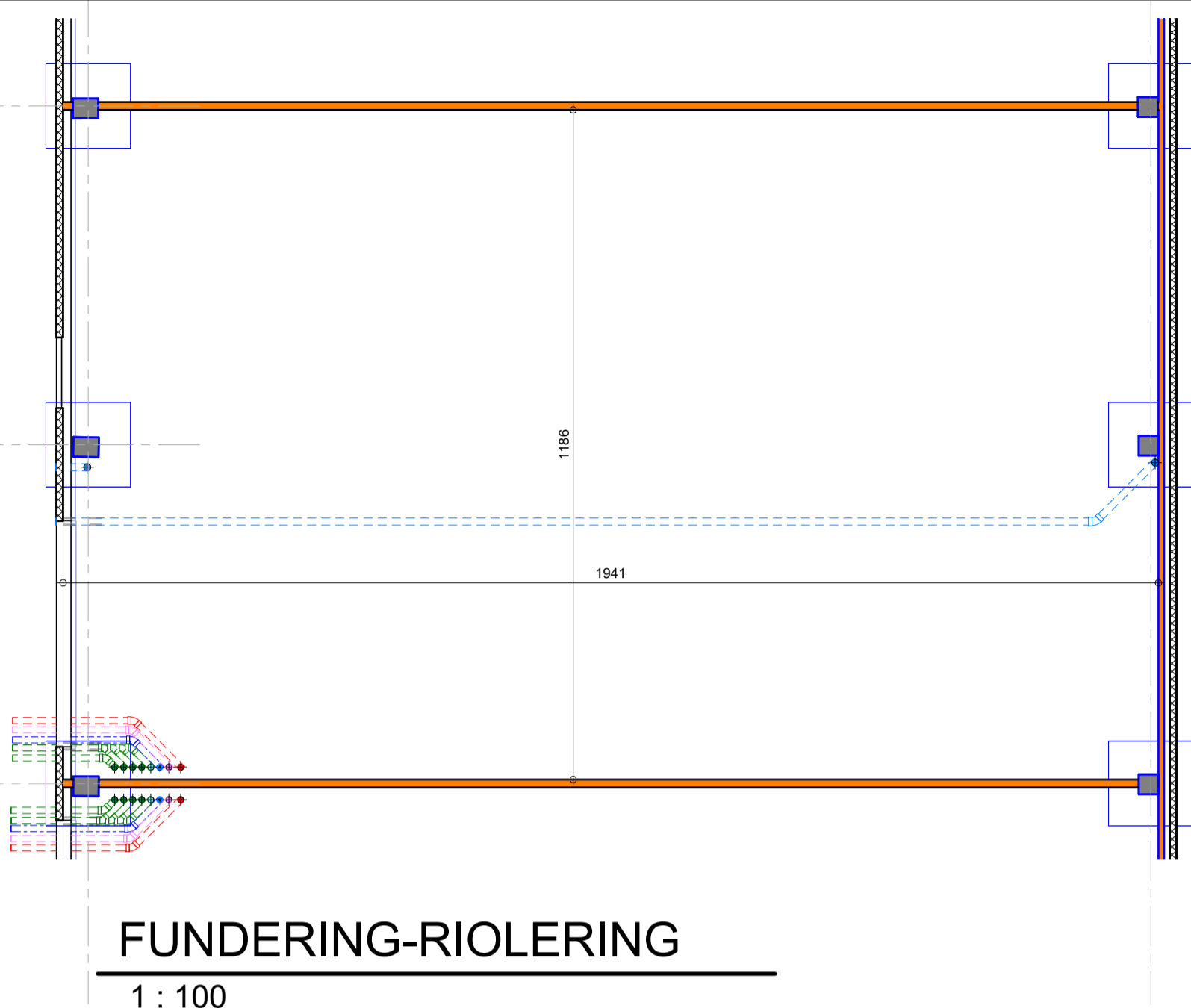

FUNDERING-RIOLERING

1 : 100

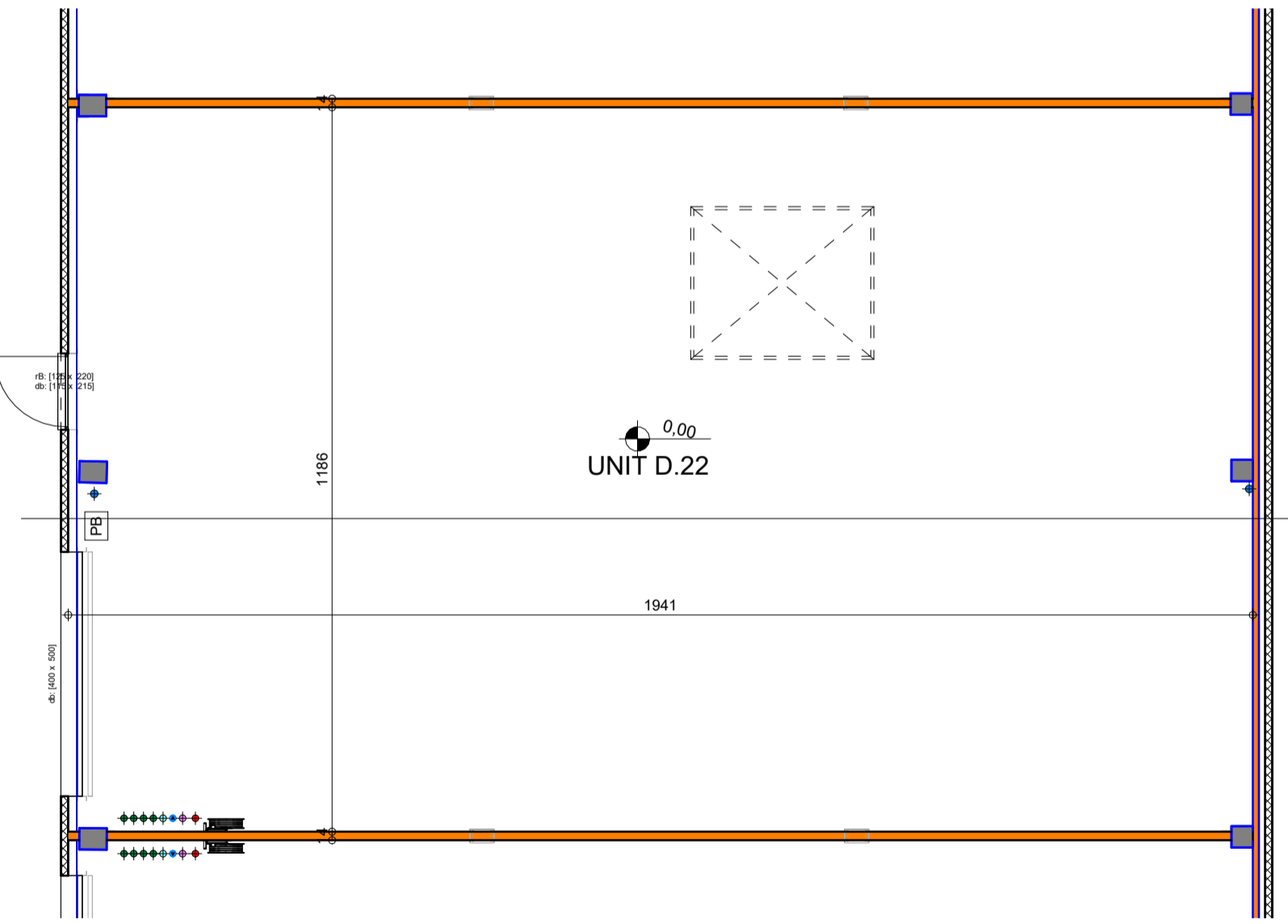

GELIJKVLOERS

1 : 100

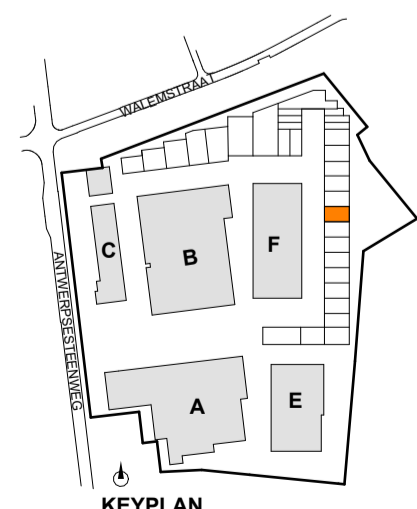

KEYPLAN

1634/22 **MARTAL BEDRIJVENCENTRUM**

UNIT 3 D.22

COM/D22/01a



WILMA WASTIAU
WILMA WASTIAU | WE FUNK INDUSTRIAL ARCHITECTURE

ARCHITECTENBUREAU WIL-MA BVBA
GENEINDE 221 - 2260 WESTERLO
T: +32 14 26 47 01
info@wilmawastiau.com
W. ALLEN ZIMMERMAN - MARIE WASTIAU

13/01/2026 IV

As indicated

a 06/03/2026

wijzigingen ifv uitvoeringsmodel aannemer

DIT PLAN IS EIGENDOM VAN HET ARCHITECTENBUREAU. HET MAG NIET GEKOPIEERD OF AAN DERDEN DOORGEGEVEN WORDEN ZONDER ONZE TOESTEMMING. OPGEGEVEN MATEN ZIJN INDICATIEF.